

PSP Magnetic Chuck



CUA / CUD Controller

Parameters: Unit (mm kg)

Model	Length	Width	Height	Net weight	Price
CUA-H	250 mm / 9.84 in	150 mm / 5.91 in	100 mm / 3.94 in	1.6 kg / 3.53 lb	\$1,216.00
CUD-H	300 mm / 11.81 in	200 mm / 7.87 in	105 mm / 4.13 in	2.0 kg / 4.4 lb	\$1,519.00

First-time magnet workholding customers!!! 12 month payment terms. Magnet, controller plus pole accessories - divide total by 13. 1/13th deposit upon order, then get invoiced every month for 12 months the same amount. Good from July 1st to December 1st 2021.

Parameters: Unit (mm kg)

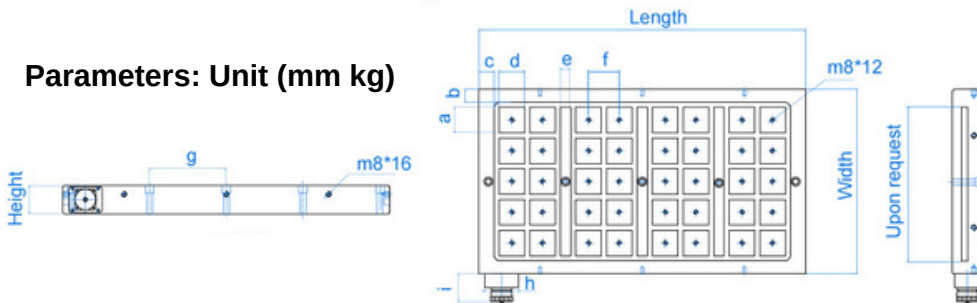

a	b	c
50 mm / 1.97 in	25 mm / 0.98 in	30 mm / 1.18 in
d	e	f
50 mm / 1.97 in	20 mm / 0.79 in	60 mm / 2.36 in
g	h	i
150 mm / 5.91 in	65 mm / 2.56 in	60 mm / 2.36 in

Model	Length	Width	Height	Pole number	Net weight	Controller	Clamping force	Price
PSP3634	340 mm / 13.39 in	360 mm / 14.17 in	59 mm / 2.32 in	20	53 kgs / 116.85 lb	CUA	70 kN	\$ 2,307.00
PSP3649	490 mm / 19.29 in	360 mm / 14.17 in	59 mm / 2.32 in	30	78 kgs / 171.96 lb	CUA	105 kN	\$ 3,463.00
PSP3664	640 mm / 25.2 in	360 mm / 14.17 in	59 mm / 2.32 in	40	101 kgs / 222.67 lb	CUA	140 kN	\$ 4,617.00
PSP3679	790 mm / 31.1 in	360 mm / 14.17 in	59 mm / 2.32 in	50	125 kgs / 275.58 lb	CUA	175 kN	\$ 5,773.00
PSP4264	640 mm / 25.2 in	420 mm / 16.54 in	59 mm / 2.32 in	48	118 kgs / 260.15 lb	CUA	168 kN	\$ 4,432.00
PSP4279	790 mm / 31.1 in	420 mm / 16.54 in	59 mm / 2.32 in	60	146 kgs / 321.87 lb	CUA (480 V)	210 kN	\$ 6,927.00
						CUD (220 V)		
PSP4294	940 mm / 37 in	420 mm / 16.54 in	59 mm / 2.32 in	72	174 kgs / 383.6 lb	CUA (480 V)	252 kN	\$ 8,312.00
						CUD (220 V)		
PSP42109	1090 mm / 42.91 in	420 mm / 16.54 in	59 mm / 2.32 in	84	201 kgs / 443.13 lb	CUA (480 V)	294 kN	\$ 9,698.00
						CUD (220 V)		
PSP4864	640 mm / 25.2 in	480 mm / 18.9 in	59 mm / 2.32 in	56	135 kgs / 297.62 lb	CUA	196 kN	\$ 6,465.00
PSP4879	790 mm / 31.1 in	480 mm / 18.9 in	59 mm / 2.32 in	70	167 kgs / 368.17 lb	CUA (480 V)	245 kN	\$ 8,082.00
						CUD (220 V)		
PSP4894	940 mm / 37 in	480 mm / 18.9 in	59 mm / 2.32 in	84	199 kgs / 438.72 lb	CUA (480 V)	294 kN	\$ 8,729.00
						CUD (220 V)		
PSP48109	1090 mm / 42.91 in	480 mm / 18.9 in	59 mm / 2.32 in	98	230 kgs / 507.06 lb	CUD	343 kN	\$11,316.00
PSP6064	640 mm / 25.2 in	600 mm / 23.62 in	59 mm / 2.32 in	72	169 kgs / 372.58 lb	CUA (480 V)	252 kN	\$ 8,312.00
						CUD (220 V)		
PSP6079	790 mm / 31.1 in	600 mm / 23.62 in	59 mm / 2.32 in	90	209 kgs / 460.77 lb	CUD	315 kN	\$10,392.00
PSP6094	940 mm / 37 in	600 mm / 23.62 in	59 mm / 2.32 in	108	248 kgs / 546.75 lb	CUD	378 kN	\$12,471.00
PSP60109	1090 mm / 42.91 in	600 mm / 23.62 in	59 mm / 2.32 in	126	288 kgs / 634.93 lb	CUD	441 kN	\$14,549.00

PLM Series Permanent Lifting Magnet



Use:

- For lifting ferromagnetic material, bar stock, hot rolled, cold rolled.

Features:

- Light and compact
- Minimum 3X safety factor
- Handles flat and round loads
- Safety device prevents accidental deactivation
- Single handed operation
- Meets BSME 30.20 standards

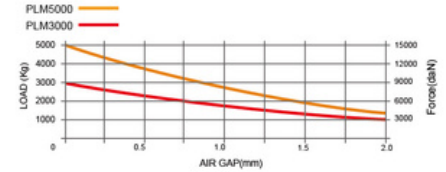
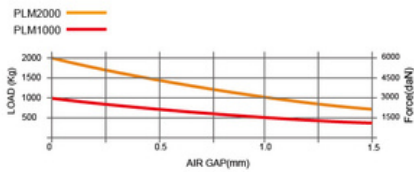
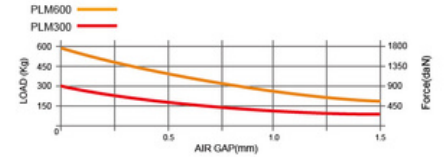
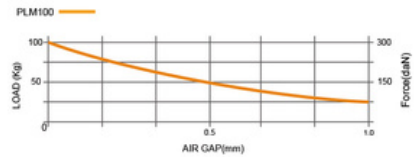
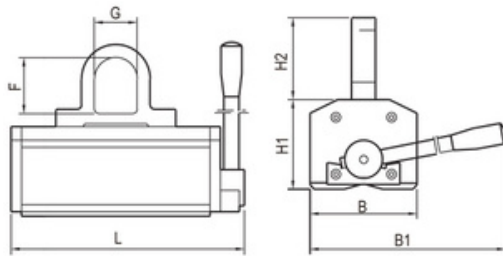

Model	Safe Working Load	B	L	B1	H1	H2	F	G	Weight	Load Plate Max	Plate Min Thickness	Plate Max Length	Load Round Max	Round Min Thickness	Round Max Diameter	Price
	kg (lb)									kg (lb)			kg (lb)			
PLM100	100 (220)	70 (2.76)	130 (5.12)	176 (6.93)	60 (2.36)	53 (2.09)	35 (1.38)	28 (1.10)	3.5 kg / 7.7 lb	100 (220)	15 (0.59)	1000 (39.37)	40 kg / 88 lb	8 (0.31)	150 (5.9)	\$ 272.00
PLM300	300 (660)	95 (3.74)	205 (8.07)	220 (8.66)	83 (3.26)	70 (2.76)	47 (1.85)	40 (1.57)	10 kg / 22 lb	300 (660)	20 (0.79)	1500 (59.06)	120 kg / 264 lb	12 (0.47)	180 (7.09)	\$ 537.00
PLM600	600 (1320)	125 (4.92)	272 (10.71)	296 (11.65)	104 (4.09)	95 (3.74)	64 (2.52)	50 (1.97)	23 kg / 50.7 lb	600 (1320)	25 (0.98)	2000 (78.74)	240 kg / 528 lb	20 (0.79)	250 (9.84)	\$ 826.00
PLM1000	1000 (2200)	160 (6.3)	318 (12.51)	410 (16.14)	140 (5.51)	95 (3.74)	64 (2.52)	50 (1.97)	44 kg / 97 lb	1000 (2200)	40 (1.57)	3000 (118.11)	400 kg / 880 lb	25 (0.98)	280 (11.02)	\$1,307.00
PLM2000	2000 (4400)	160 (6.3)	496 (19.53)	508 (20)	140 (5.51)	120 (4.72)	80 (3.15)	60 (2.36)	72 kg / 158.7 lb	2000 (4400)	55 (2.17)	3000 (118.11)	800 kg / 1760 lb	35 (1.38)	350 (13.78)	\$2,392.00
PLM3000	3000 (6600)	230 (9.06)	510 (20.07)	600 (23.62)	212 (8.35)	155 (6.1)	100 (3.94)	70 (2.76)	160 kg / 352.7 lb	3000 (6600)	70 (2.76)	3500 (137.8)	1200 kg / 2640 lb	45 (1.77)	400 (15.75)	\$4,077.00
PLM5000	5000 (11000)	360 (14.17)	725 (28.54)	980 (38.58)	261 (10.28)	180 (7.09)	100 (3.94)	70 (2.76)	450 kg / 990 lb	5000 (11000)	85 (3.35)	4000 (157.48)	2000 kg / 4400 lb	55 (2.17)	450 (17.7)	\$6,785.00

Contact your local distributor today:



**METAL CUTTING[®]
SPECIALISTS**
FULL CIRCLE SOLUTIONS